

MOTOMAN SG400

Picking, Packing & Handling
with the SG-series

The robust MOTOMAN SG400 scara-robot features a wide motion range due to its compact design.

It is particularly suitable for application when high speed and accuracy is required, for example picking and packing, dispensing and feeding. Small interference contours allow the robots working together in confined spaces. Internal cabling enables a reliable workflow and saves extensive maintenance.

The SG400 is driven by the compact and lightweight YRC-1000micro controller.



KEY BENEFITS

- Fast, powerful and reliable
- Wide motion range
- Compact and robust design
- Internal cabling
- High repeatability and accuracy
- Ideal for applications in confined spaces
- Easy integration and high dynamics
- Easy maintenance

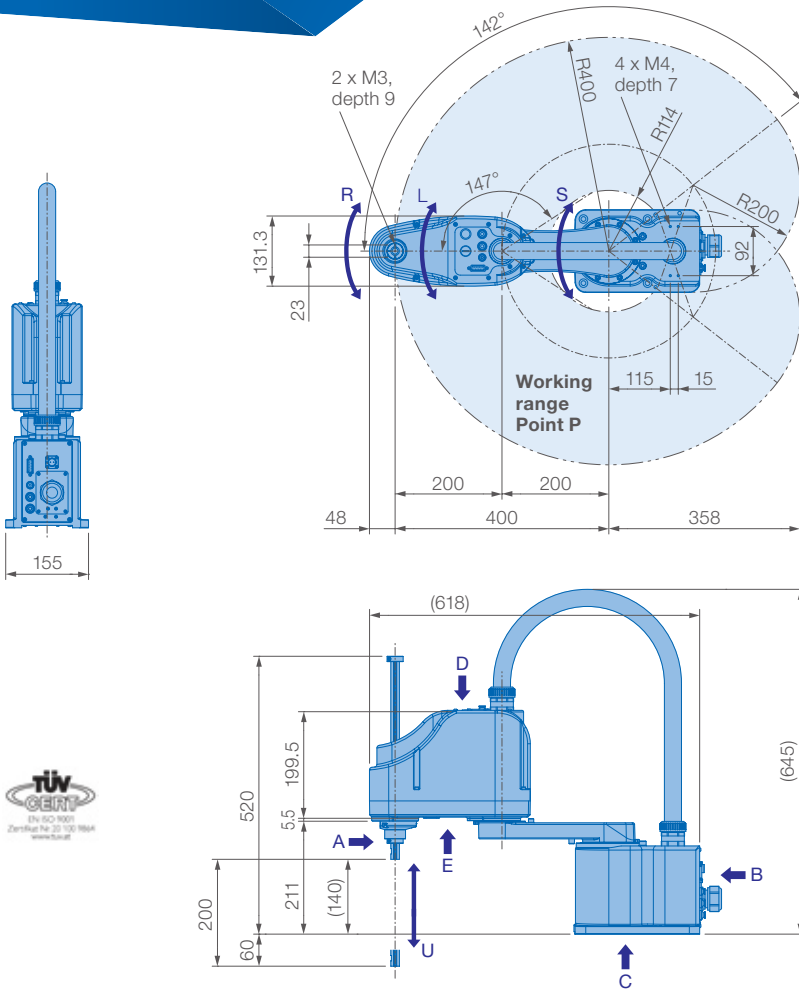

View A

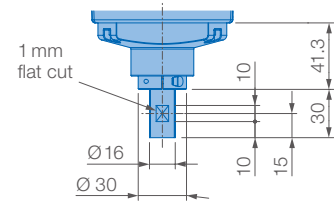

View B

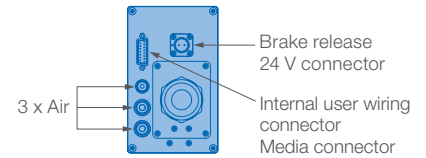

View C

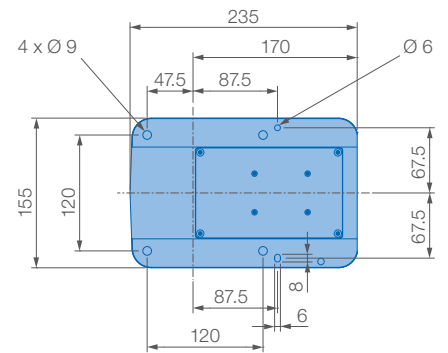

Mounting option: Floor



Maximum payload of the wrist axis and the R-axis allowable inertia

Please make sure that the load (total amount of hand and workpiece) does not exceed the values in the table.

Max. Payload [kg]	3
R-axis allowable inertia [kg · m ²]	0.06
Max. allowable eccentric distance of the mass center point [mm]	150

View D

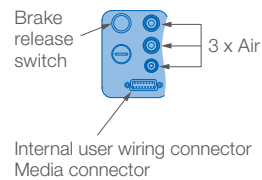

View E

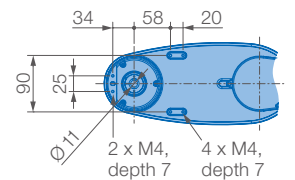

Specifications SG400					
Axes	Maximum motion range [°]	Maximum speed [°/sec.]	Allowable moment [Nm]	Allowable moment of inertia [kg · m ²]	Controlled axes
S	±142	740	-	-	4
L	±147	800	-	-	Max. payload [kg]
U	+200	1200 mm/sec.	-	-	Repeatability [mm]
R	±360	3000	-	0.06	Max. working range R [mm]
					Temperature [°C]
					Humidity [%]
					Weight [kg]
					Power supply, average [KVA]

Yaskawa Europe GmbH

Robotics Division
Yaskawastraße 1
85391 Allershausen
Germany

Tel. +49 (0) 8166 90-0
robotics@yaskawa.eu.com
www.yaskawa.eu.com

YR-1-04SX400-A00
A-03-2020, A-No. 210156